



मल्हार  
अ पा र् ट म् एं ट



मल्हार  
अपार्टमेंट



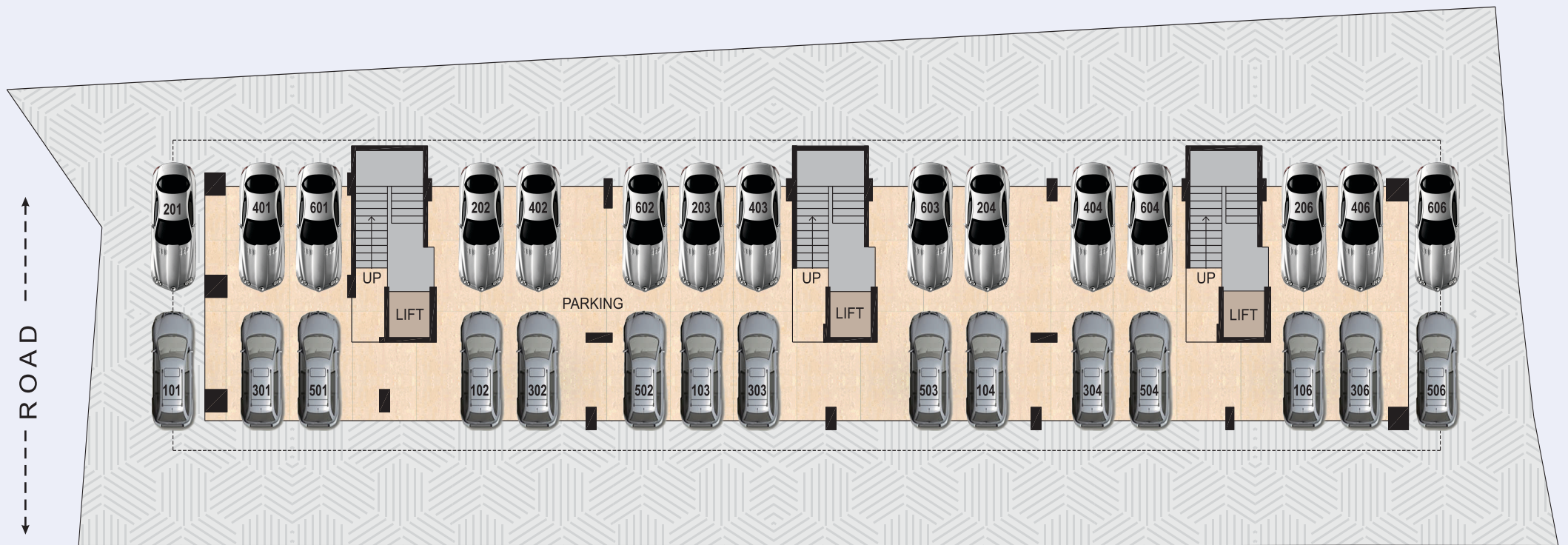

GROUND FLOOR PLAN



Flat No.	Carpet Area
101 - 601	757 SQFT
102 - 602	692 SQFT
103 - 603	807 SQFT
104 - 604	706 SQFT
105 - 605	617 SQFT
106 - 606	730 SQFT

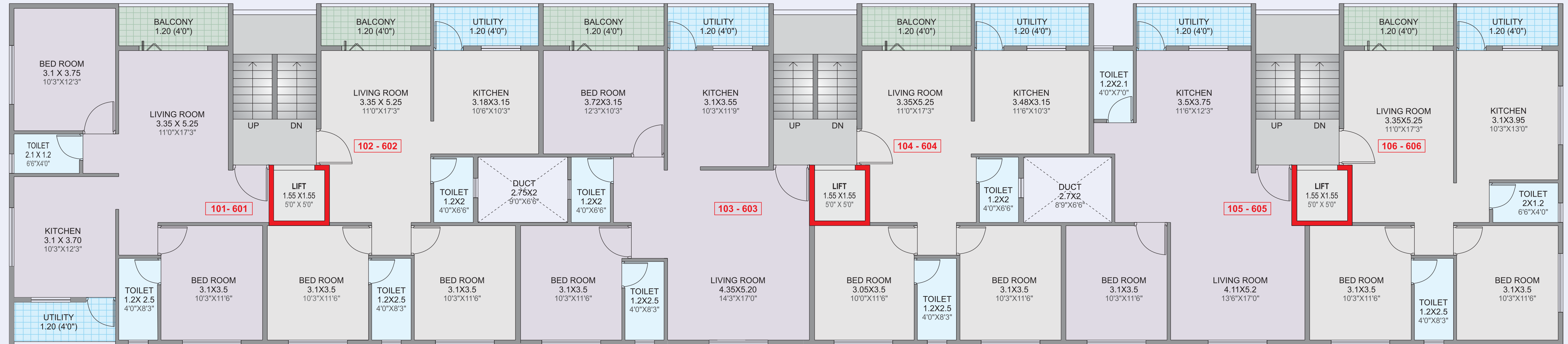

TYPICAL 6 FLOOR PLAN



# SPECIFICATIONS



## Structural Design

- R.C.C Frame structure.
- Internal brick work: 4" AAC block / Red Brick.
- External brick work: 6" AAC block / Red Brick.
- Internal plaster: Plaster with Sanla Finish.
- External plaster: Double coat sand faced plaster.



## Flooring & Wall Tiles

- Flooring: Vitrified tiles – 600x600 mm.
- Kitchen platform: Black granite with SS sink.
- Toilets flooring: Anti-skid vitrified tile.
- Toilets wall tiles: Glazed tiles.
- Window sills: Granite.
- Brick bat coba water proofing at terrace.



## Doors & windows

- Main door: Main doors with both side laminations with Godrej/ Equivalent latch.
- Other doors: Flush doors.
- Toilets doors: Toilet doors are granite frame with FRP coated doors.
- Windows: Powder coated aluminium windows with mosquito net (3 tracks).



## Lift

- Automatic open / close door
- ERD System
- Invertor Backup



## Plumbing

- Underground & Overhead tank: RCC tank.
- C P Fitting: Branded.
- Branded CPVC & UPVC pipe for toilet works.



## Electricals

- Wiring: Concealed copper wiring.
- T. V. Cable in living room.
- Inverter backup point.
- A.C point in bedrooms.
- Branded electrical fittings fixtures.



## Paint | Grill | Railing

- Internal paint: Plastic emulsion.
- External paint: Anti weather proof emulsion.
- Grills: M.S. designer grill for windows.
- Staircase: Stainless steel designer railing.



## Parking

- Parking space with paving blocks/ parking tiles/ trimix.



## Solar System

- 10 kw 3-phase On-Grid Solar power Plant

## Completed Project

### Venkatesh Residency

Opp. MIT College

### Radha Govind Apartment

24, Jai Nagar

### Geetai Enclave

Vishwabharti Colony

### Raghuveer Sadan

12, Mehar Nagar

### Tirumala Hills

Nathprangan, Garkheda

### Pushpak Apartment

62, Jai Nagar

### Durvankur Apartment

Beed Bypass

### Ambika Apartment

Nathprangan, Garkheda

Project by :

 **MG Kulkarni**  
CIVIL ENGINEER AND DEVELOPERS

📍 Office : UL-12, Chetan Super Market,  
Near Trimurti Chowk, Hedgewar Hospital Road,  
Chhatrapati Sambhajinagar - 431005

✉ E-mail : [info@mgkulkarni.com](mailto:info@mgkulkarni.com)

🌐 Web: [www.mgkulkarni.com](http://www.mgkulkarni.com)

Architect  
**Archipel Architects**

RCC Consultant  
**ICON Consultant**

Contact

**7745009991** 

Channel Partner



**Govind Krupa  
Properties**

Contact

**8007575555** 

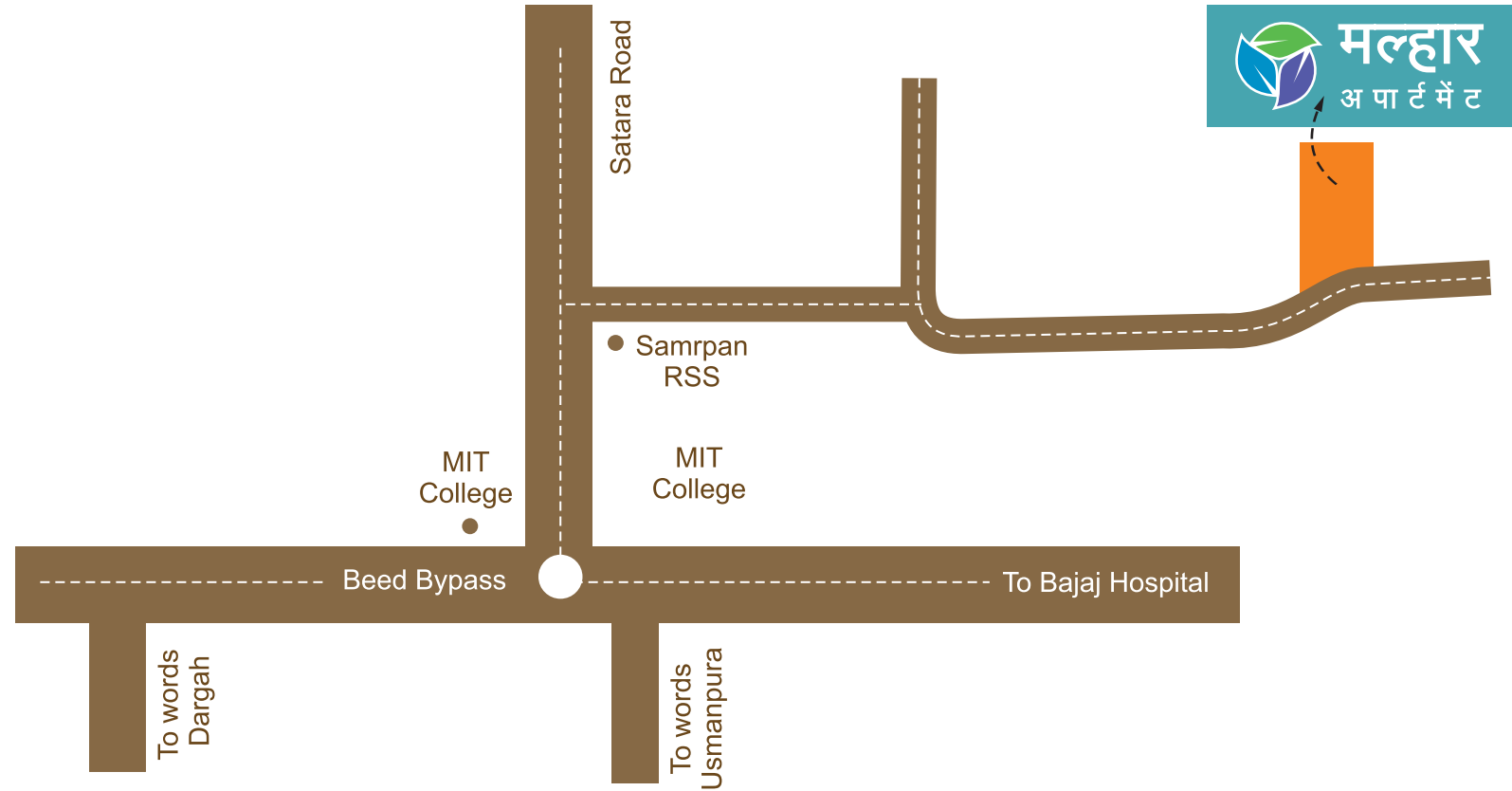

#### SITE ADDRESS :

Malhar Apartment, Plot No. 29, Survey No. 53/ Part,  
Behind Mit College, Satara, Chhatrapati Sambhajinagar- 431005.

Member  
**CREDAI**  
CHHATRAPATI SAMBHAJINAGAR



**MAHARERA**  
**PR1040002500753**

